

Plunger Height Gauge

These are designed for checking the plunger diameter at a specific height

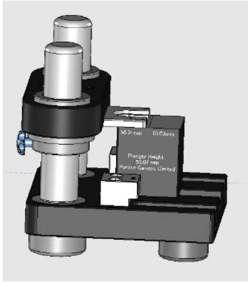

1. Setting to correct height

- a. Insert Relevant Gauge for plunger \varnothing and set to correct height using the correct setting block. This can be adjusted by releasing the clamping screws and adjusting the height with the Fine adjustment screw. Making sure the Gauge locates between the stepped faces.

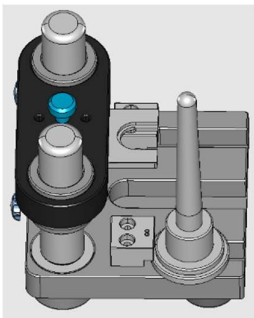

2. Plunger Flange Inspection, Go Dimension

- a. Place Plunger Flange under the Go Gauge, the Flange should enter the Gauge.

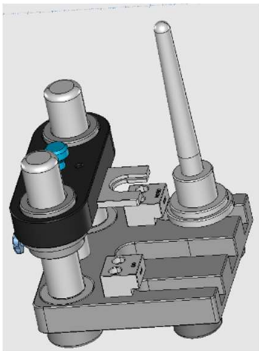

3. Plunger Flange Inspection, No Go Dimension

- a. Place Plunger Flange under the No Go Gauge, the Flange should not enter the Gauge.

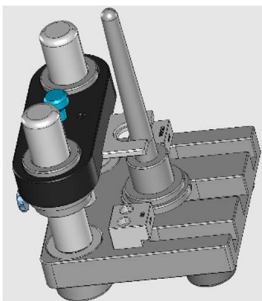

4. Checking Plunger intersection \varnothing

- a. At the correct gauge height slowly place the plunger between the gauge forks.

If the plunger passes the go dimension and fails to enter the NOGO dimension, the plunger is OK.

For Visual instructions Follow Link <https://www.youtube.com/watch?v=KpicFQeQnfw>

Plunger Height Gauge

These are designed for checking the plunger diameter at a specific height

